

ISOTOPE FUME HOODS

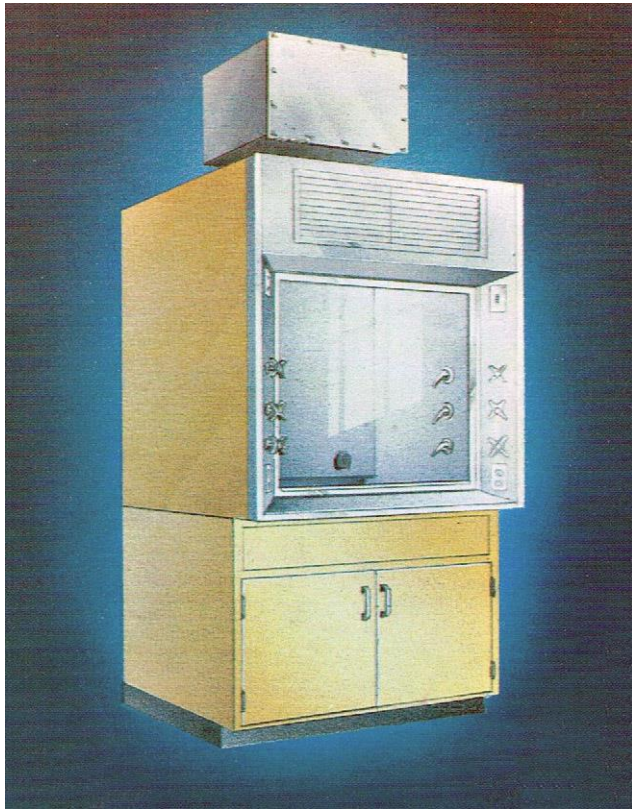

To facilitate decontamination, this series of radiochemical fume hood superstructure has interior fabricated of Type 316 stainless steel, with coved vertical interior corners and coved working top. The top is 14 ga. thickness reinforced with a 1" thick steel grate to support heavy shielding. Both fixed and adjustable lower and upper baffles are removable for decontamination. The entire face of the superstructure is of stainless steel with an air by-pass grille in the spandrel above and a concealed by-pass below the lower foil. The counter-balanced stainless steel sash has safety glass. The exterior is fabricated of electro zinc plated steel with an acid resistant finish.

Accessories include a 6" diameter stainless steel cup sink integral with top, a blower with pilot light, a light switch for the vapor proof fluorescent light, four 110 volt AC receptacles and remote control valves for two cold water, two gas and two air cocks.

Base Cabinets and filter boxes are sold separately.

Overall size of superstructure including base is 34" wide, 7'-2" high, and of length as selected. A clearance of approximately 9'-8" in height is required for hood with filter box.



END VIEW

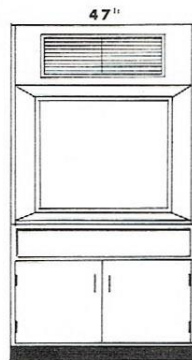

FUM-447

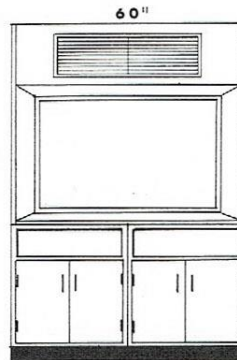

FUM-460

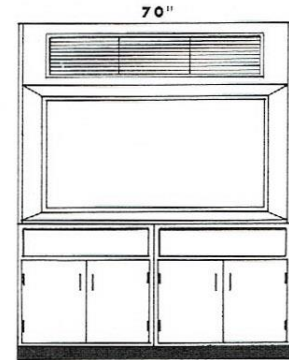

FUM-470

FUM-400 Filter Box Assembly

The FUM-400 Filter Housing is fabricated of Type 316 stainless steel and has a removable front panel for removal and disposal of filters contaminated with radioactive particles. Each Filter Box is sold equipped with an FUM-402 pre-filter, 24" x 24" x 2", and with an FUM-403 micronite absolute filter 24" x 24" x 11-1/2", having an efficiency of 99.97% on particles of 0.3 micron size.